

LED Lights

Specifications

Colour:	Red or green LED's
LEDs per Enclosure:	4
Reverse Polarity:	Not recommended
Brightness:	Typically 2400mlm
Operating Temperature:	-40°C to +100°C
Voltage:	12V ±3V
Current:	45mA
Operation:	Continuous or intermittent*
Reverse Polarity:	Not recommended
Expected Life:	50,000 hours to 50% brightness ≥ 50°C

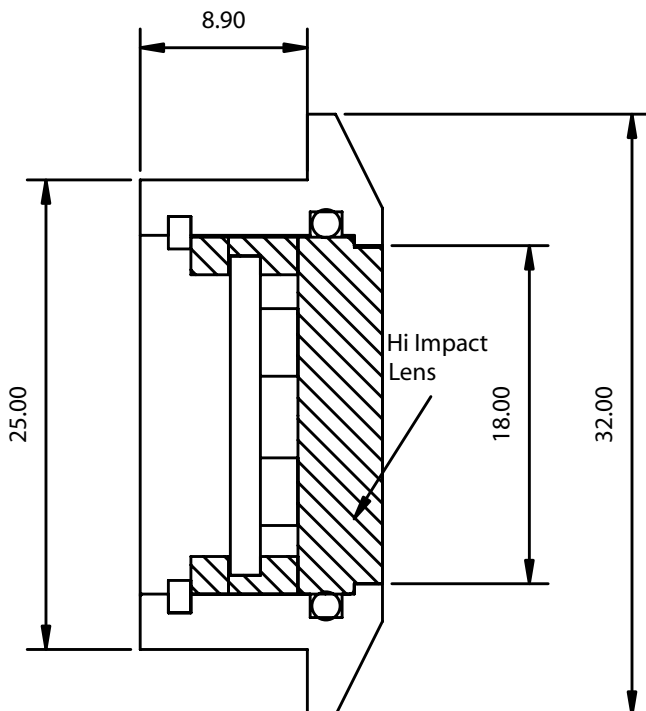

*Requires additional 3rd party circuitry to operate

T 09 276 0800
F 09 276 2525

E info@csfordoors.co.nz
W www.csfordoors.co.nz

Another quality product from:



5 - 7 Rakino Way
Mt Wellington, Auckland