

# Heavy Duty Push Button

## Features

For 12V and 24V DC applications

Designed for rough treatment

All non-corroding materials:

- Solid brass body with satin chrome plating
- Special plastic button
- Screw terminals
- Stainless steel springs & screws
- Stainless steel locking nut

Normally open/momentary contacts

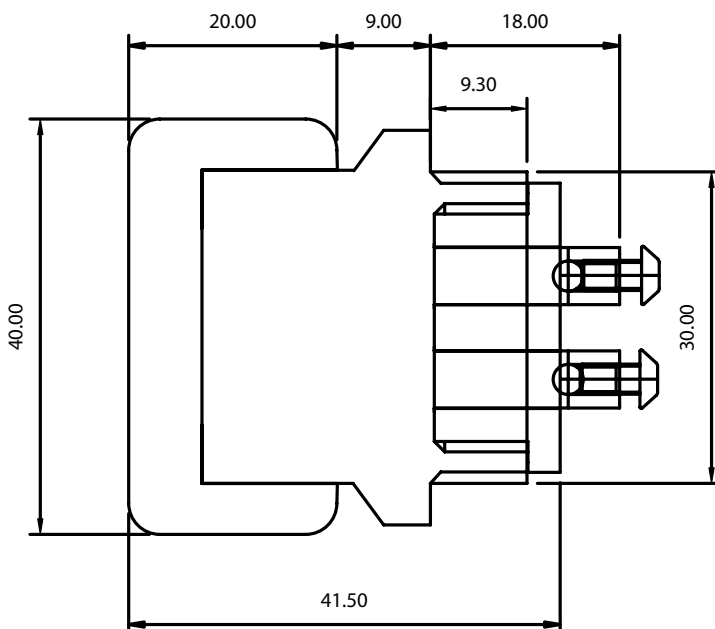

T 09 276 0800  
F 09 276 2525

E [info@csfordoors.co.nz](mailto:info@csfordoors.co.nz)  
W [www.csfordoors.co.nz](http://www.csfordoors.co.nz)

Another quality product from:

 **FOR D I I R S**<sup>®</sup>

5 - 7 Rakino Way  
Mt Wellington, Auckland