

CL100 Louise

The **Louise** range of door hardware is specifically designed to work with the **CL100 Mortice Lock**. It can be factory fitted to our **CS NewYorker** glazed doors or the **CS AluTec** and **CS AluLite** aluminium doors.

The 190mm long face plates of the Louise can be the same on each side of the door or different, depending on the configuration required.

The Louise can be set up to as latching only, security with key access or for privacy (such as a bathroom) there are many options available.

Requires minimum door thickness of 37mm.

Finishes available: SCP or PB.

Dimensions

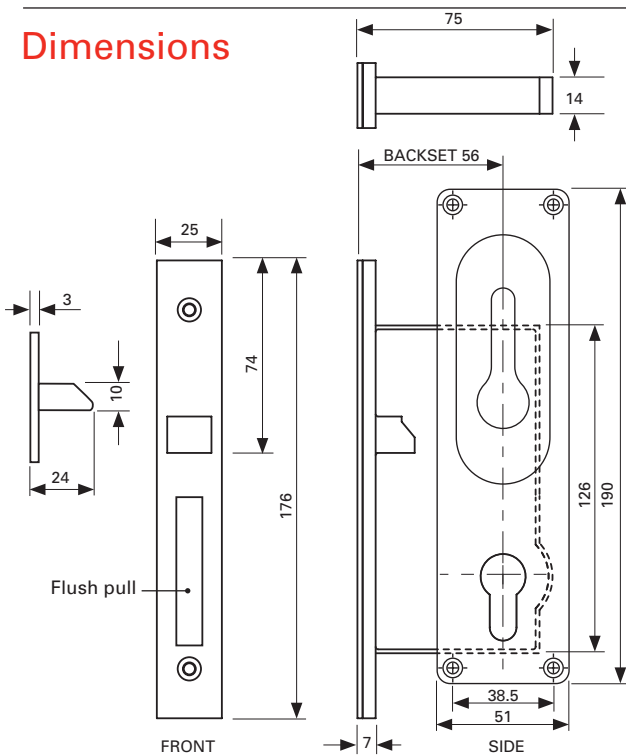

Each Louise plate has a recessed edge pull with a lever if required to release the latch. The bottom half has one of the following:

- A** Plain finished plate
- B** Slide locking button
- C** Emergency release
- D** Euro Cylinder

These side plates can provide a latching function along with:

- Key/Key (Locking)
- Key/Blank (Locking)
- Slide Lock/ Emergency Release (Privacy)
- Blank/Blank (Latching only)

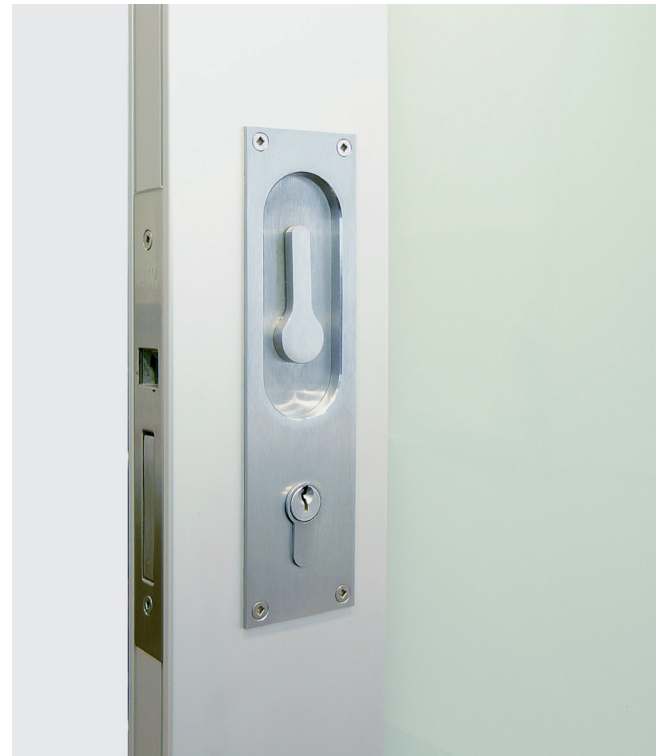
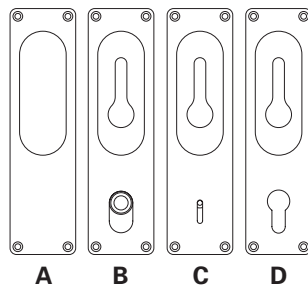

▲ A satin chrome key locking Louise fitted to a CS NewYorker door.

Flush Pulls

All CL100 Lock Cases come with the option of a built-in Flush Pull in either Stainless Steel or Brass.

This Flush Pull is designed for use on doors which slide completely inside a cavity pocket.



▲ Satin Chrome Louise fitted to a CS NewYorker door.

Finish Options & Configurations

▀ Satin Chrome

CL100A9010 (Latching)
CL100A1016 (Key/Key)
CL100B1014(LH) (Snib/Emerg)

▀ Polished Brass

CL100A9011 (Latching)
CL100A1017 (Key/Key)
CL100B1015(LH) Snib/Emerg

For other configurations, including Exit Free functionality, please refer to the CL100 brochure (available from the CaviLock section on our website).

Drawings & pictures are not to scale. All dimensions in millimetres. © Cavity Sliders Limited.

Bay of Plenty / Waikato
T 07 928 0800
F 07 928 2525

Christchurch
T 03 348 6158
F 03 348 6150

Wellington
T 04 473 9994
F 04 473 9995

Auckland Head Office
T 09 276 0800
F 09 276 2525