

FramelessGlass™

Cavity sliders are all about space. The term 'cavity slider' refers to the cavity pocket (incl. track + carriages) installed within wall framing that allows a door to <slide> inside the wall. The benefit is a solution that leaves clear space on both sides of the wall and opening, encouraging cohesion between spaces.

A **CS FramelessGlass** unit is distinctive. It uses a glass door leaf instead of typical wooden doors. The glass can provide a clear and unobstructed view through the doorway whether the door is open or closed.

CS FramelessGlass is a cavity slider that has a toughened glass sheet fitted for a door.

Frosted glass and other finishes, including 'branded options' are available for privacy.

Regardless of the glass finish you choose, light can pass through the door and between spaces.

The translucent nature of a glass door provides an increased outlook and enhanced feeling of spatial flow.



↑ 1 - Automated CS FramelessGlass Single unit with frosted glass door in an operating theatre.

See-through Space

Design Features & Options

- ▮ Various glass door options available including clear, frosted and tinted.
- ▮ Designed to fit into standard wall framing (90 x 45mm kiln dry).
- ▮ Available as Single or Bi-Parting double units.
- ▮ Can be supplied in two ways:
 1. Clamp bracket (that holds the glass) hidden above head jambs - gives a clean look.
 2. Clamp bracket visible below head jambs - access to carriages is easy and clearance is increased between floor and underside of head jambs.
- ▮ Supplied with wool-pile brush seals fitted to the jambs, which protect and help guide the glass door.
- ▮ Toughened glass door is very stable even in varying temperatures.
- ▮ The glass has an STC rating of 31, which aids in the sound reduction quality of the overall product.



▮ 3 - Single unit with 10mm toughened Color Bak glass 'Resene Pursuit'



▮ 4 - CS FramelessGlass Single unit with tempaclad frosted glass door.

▮ 2 - Two CS FramelessGlass Single units with frosted glass doors and custom s/steel handles fitted.

Why specify CS CavitySliders?

Quality

Our aim is to make the best quality cavity sliders. Therefore, every component is uniquely designed with this in mind.

Technology & Innovation

Our engineers focus on constantly developing new products & refining existing ones. That's why our products come with a number of unique features. A few exclusive **CS CavitySliders** features (refer to pics on left):

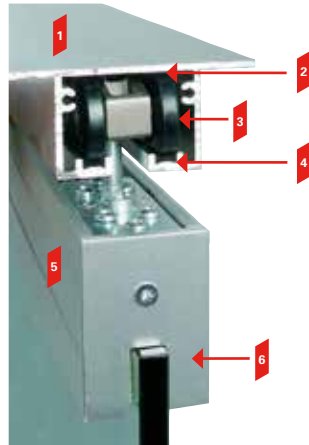

- 1 Heavy duty **one-piece** extruded aluminium track.
- 2 Minimal carriage clearance inside the track ensures the door can't become jammed or jump off the track.
- 3 Large diameter wheels with precision ground bearings ensure smooth running on carriages for years to come.
- 4 Radiuses on track surfaces reduce friction and prevent dust build up on carriages.
- 5 Glass clamp rail.
- 6 Removable end cap.
- 7 4-wheel carriages are standard on all CS FramelessGlass units.
- 8 **CarriSnap™** quick release system allows easy removal of the door from the cavity pocket.

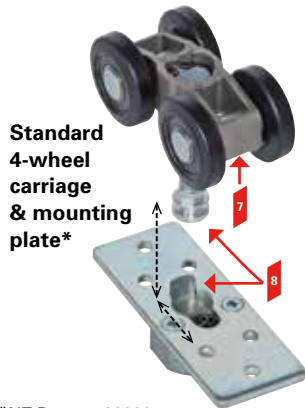

*NZ Patent 533838.
Aust patent 2005 202818 (2011)

Service

The only New Zealand manufacturer of cavity sliders to have NZ covered with 4 branches. All branches offer a free site measure & quote.

We're Local

CS FOR DOORS is 100% New Zealand owned and our products are 100% New Zealand Made.



📍 *Come see our door systems at CS FOR DOORS' NZIA Award winning Head Office & Showroom.*

Product Range

We have over 50 standard products, or if you have other ideas we can make to order.

Quality Assured

CS CavitySliders are BRANZ appraised.



Our Guarantee

WE GUARANTEE PRODUCT WITH OUR SERIAL CODES FOR UP TO TEN YEARS*

*Guarantee conditions apply. Contact CS FOR DOORS for details.

Check out the full range of products and use our online calculator at:

www.csfordoors.co.nz

Technical Information

How to specify (example)

Product:	~ CS FramelessGlass by CS FOR DOORS
Location:	~ Meeting room
Door leaf dimensions:	~ 2052 mm x 760 mm
Door type:	~ 10mm toughened glass
Glass finish:	~ Etchlite
Single or Bi-Parting:	~ Single
Jamb type & finish:	~ Grooved (for wall linings); Clear pine
Framing size & material:	~ 90 mm timber framing
Wall lining thickness:	~ 10 mm
Gear type & finish:	~ CS 240kg track system & FramelessGlass clamp
Handle type:	~ 10mm glass D-pull handle

Full specifications are available on www.masterspec.co.nz

Plan view (CAD)

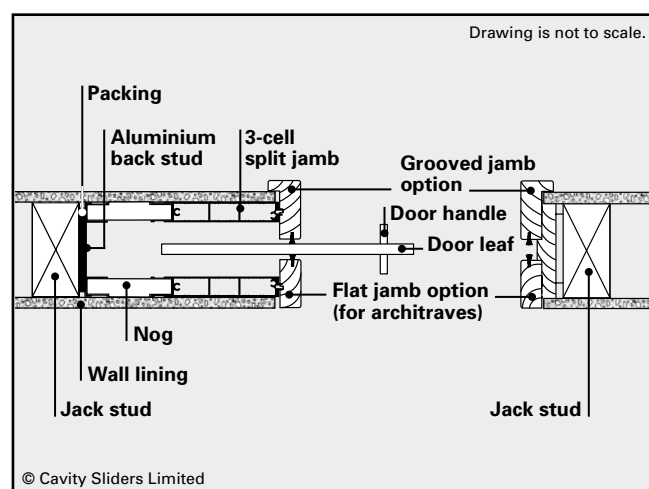

Elevation (CAD)

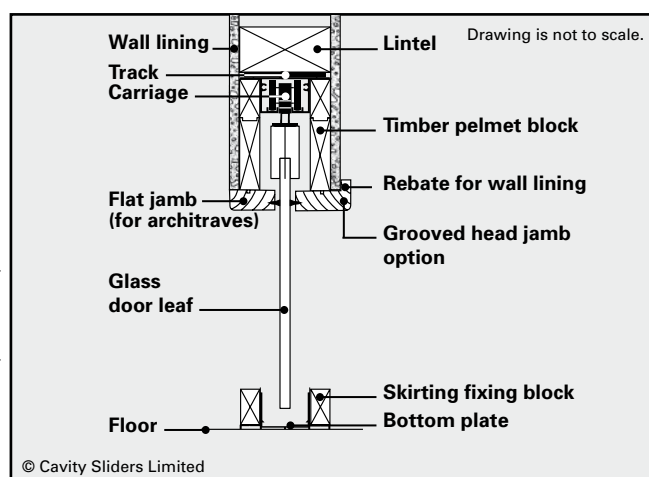

Useful formulas (online calculator @ www.csfordoors.co.nz)

Dimension Required	Single	Bi-Parting
Trim height*	DH + 95	DH + 95
Trim width*	(DWx2) - 70	(DWx4) - 190
Distance between jambs*	DW - 31	(DWx2) - 42
Distance over jambs (Arch)	DW + 13	(DWx2) + 6
Distance over jambs (Grvd)	DW + 31	(DWx2) + 20
Floor to top of head (Arch)	DH - 33	DH - 33
Floor to top of head (Grvd)	DH - 22	DH - 22
Floor to underside of head*	DH - 53	DH - 53

DH = Door Height DW = Door Width
 * = Same calculations for both Architrave (Arch) & Grooved (Grvd) jambs
 Note: All dimensions are in millimetres

Detail Options

- ▣ Full-Height™
- ▣ CornerMeeting™
- ▣ ShadowLine™
- ▣ SquareStop™

Check out our detail options in more detail online:
www.csfordoors.co.nz

Incorporate any of the above architectural detail options with the CS FramelessGlass cavity slider to create a specific look or to provide a unique solution.

Standard CS FramelessGlass Features

- 1 **Trim height**
- 2 **Trim width**
- 3 **Lintel**
Is part of the framework.
- 4 **Closing jamb**
Always quoted as standard. Can be omitted if not needed.
- 5 **Jamb liners**
Available as:
 - flat jambs ready for architraves or
 - grooved for wall linings.
 - jambs fitted with brush seals to protect and guide door.
- 6 **Track in one piece**
Heavy-duty aluminium.
- 7 **Back stud**
Strong and made of reliable, heavy-duty aluminium.
- 8 **Split jambs**
3-Cell aluminium split jamb for strength.
- 9 **Bottom plate**
One-piece in aluminium.
- 10 **Pine nogs**
Fitted on both sides and offset for adjacent wall fixing.

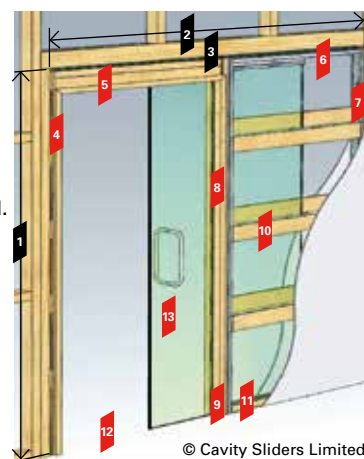

If extra fixing is required then in some cases extra nogs can be supplied or even a full sheet of ply on one side.

- 11 **Skirting blocks**
On either side of the bottom plate, to fix both linings and skirting.
- 12 **No visible floor track or guide.**
The door opening is always clear.
- 13 **Frameless glass door leaf**
Normally supplied as 10mm or 12mm thick toughened glass.

Cavity Sliders Limited
Auckland Head Office
 5 - 7 Rakino Way
 Mt Wellington
 PO Box 112349, Penrose
 Auckland 1642, NZ
 T 09 276 0800
 F 09 276 2525
info@csfordoors.co.nz

www.csfordoors.co.nz
Bay of Plenty / Waikato
 40 Newton Street
 Mt Maunganui
 T 07 928 0800
 F 07 928 2525
salesbop@csfordoors.co.nz

info@csfordoors.co.nz
Wellington
 33 Grenada Business Park
 16 Jamaica Drive
 Grenada North
 T 04 473 9994
 F 04 473 9995
saleswgt@csfordoors.co.nz

A division of:

 Innovative door solutions
Christchurch
 6 Marylands Place, Middleton
 T 03 348 6158
 F 03 348 6150
saleschch@csfordoors.co.nz

Pull Handles for Frameless Glass Cavity Sliders

Handles & Locks for Sliding Doors

Turin

Door Thickness: Glass 10mm to 12mm
Timber/Aluminium 35mm to 50mm
Fixing: Back to back only
Material: Satin Stainless Steel
Door Type: Timber, Aluminium or Glass
CS Code: CL800A5009

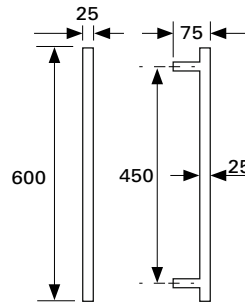

Dalco 1213 D-Pull

Door Thickness: Glass 10mm to 12mm
Fixing: Back to back only
Material: Satin Stainless Steel
Door Type: Timber, Aluminium or Glass
CS Code: CL800A5006

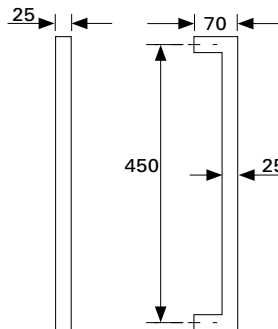

Windsor Tubular Pull

Standard sizes range from 300mm to 1200mm (A)
Fixing: Back to back pairs
Also available as singles with face fix or rear through door fixing
Material: Marine Grade Stainless Steel
Door Type: Timber, Aluminium or Glass

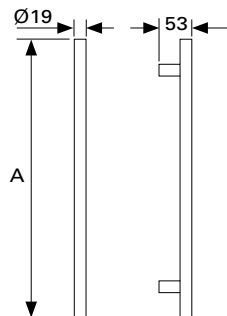

Asso Pull Handle

Door Thickness: Glass 10mm to 12mm
Timber 40mm to 52mm
Fixing: Back to back only
Material: Brushed Stainless Steel
Door Type: Timber, Aluminium or Glass

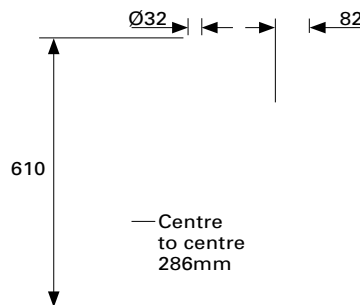

Windsor Locking Pull

Fixing: Back to back only
Material: Stainless Steel
Door Type: Timber, Aluminium or Glass

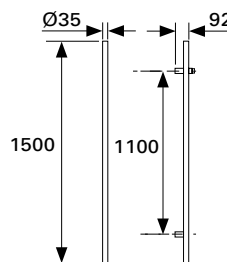

Drawings & pictures are not to scale. All dimensions in millimetres. © Cavity Sliders Limited.

Bay of Plenty / Waikato
T 07 928 0800
F 07 928 2525

Christchurch
T 03 348 6158
F 03 348 6150

Wellington
T 04 473 9994
F 04 473 9995

Auckland Head Office
T 09 276 0800
F 09 276 2525